

LONSDALE LAVATORY WITH LOW LEVEL CISTERN

The Lonsdale lavatory pan is shown with a low level cistern, matt black painted wooden seat and a graphite flush handle. It can be used with a high level or a concealed cistern.

Produced in a traditional manner in England.



Side view

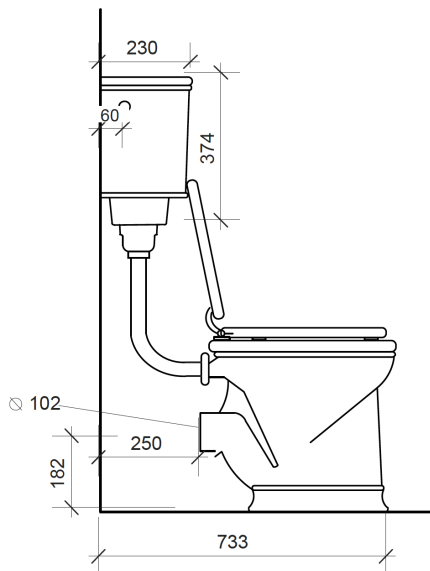

Front view

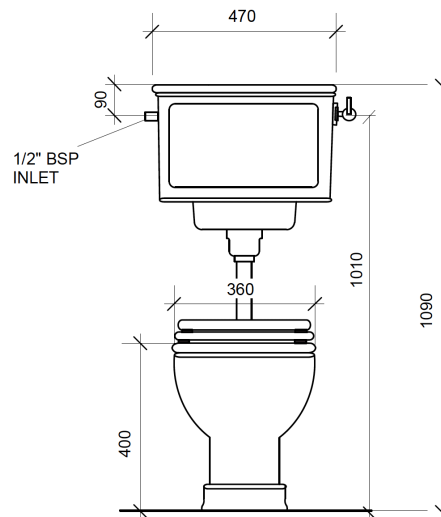

Cistern inlet pipe position diagram

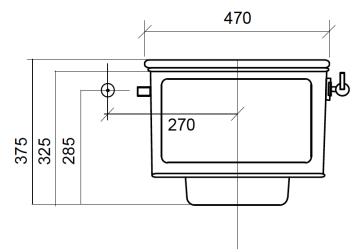

Side view with optional vertical pan connector

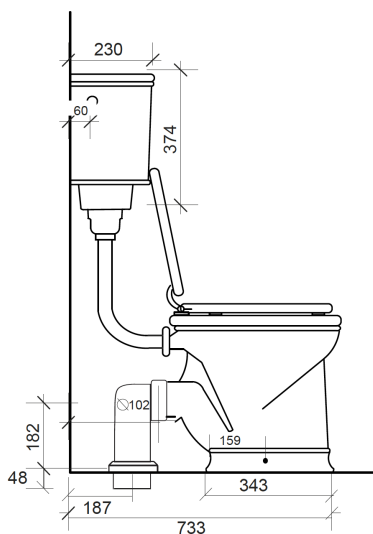

Side view with optional horizontal pan connector

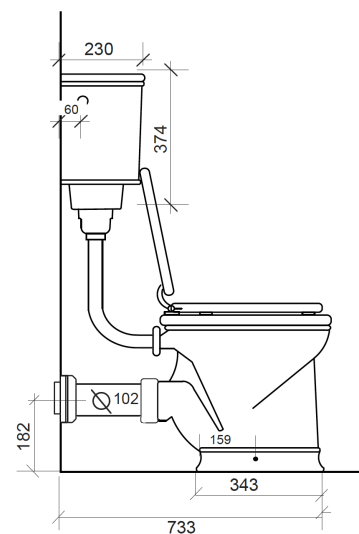

LONSDALE LAVATORY PAN WITH LOW LEVEL CISTERN

(page 2/2)

Horizontal pan connector

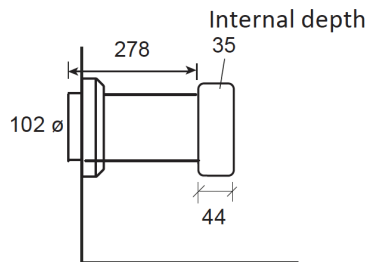

Vertical pan connector

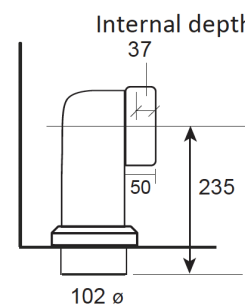

Collar for horizontal and vertical pan connector

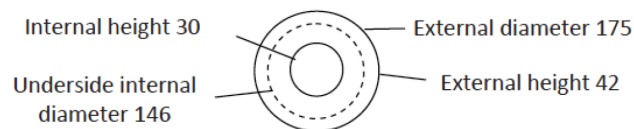

Technical Details

Flush motion: Syphonic with flush handle

Depth: 733mm

Height: 1090mm

Inlet connection size: 1/2"

Inlet connection type: Male BSP

Cistern width: 470mm

Rim height: 400mm

Water Pressure Maximum: 6 bar

Water Pressure Minimum: 1 bar

Outlet size: 102mm

Water consumption 6 litres

Optional china pan connector, straight or 90° available

Fixing is through side of pan on to horizontal bent brackets under the pan (supplied)

Codes & Standards

Ceramic complies to CE Standards

Flush mechanism complies to WRAS Standards



Product Notes

All dimensions are based on original specifications and are subject to change and variation.